

PART LIST AND DIAGRAM  
Pneumatic Airless Pump 12000 P - (40:1)

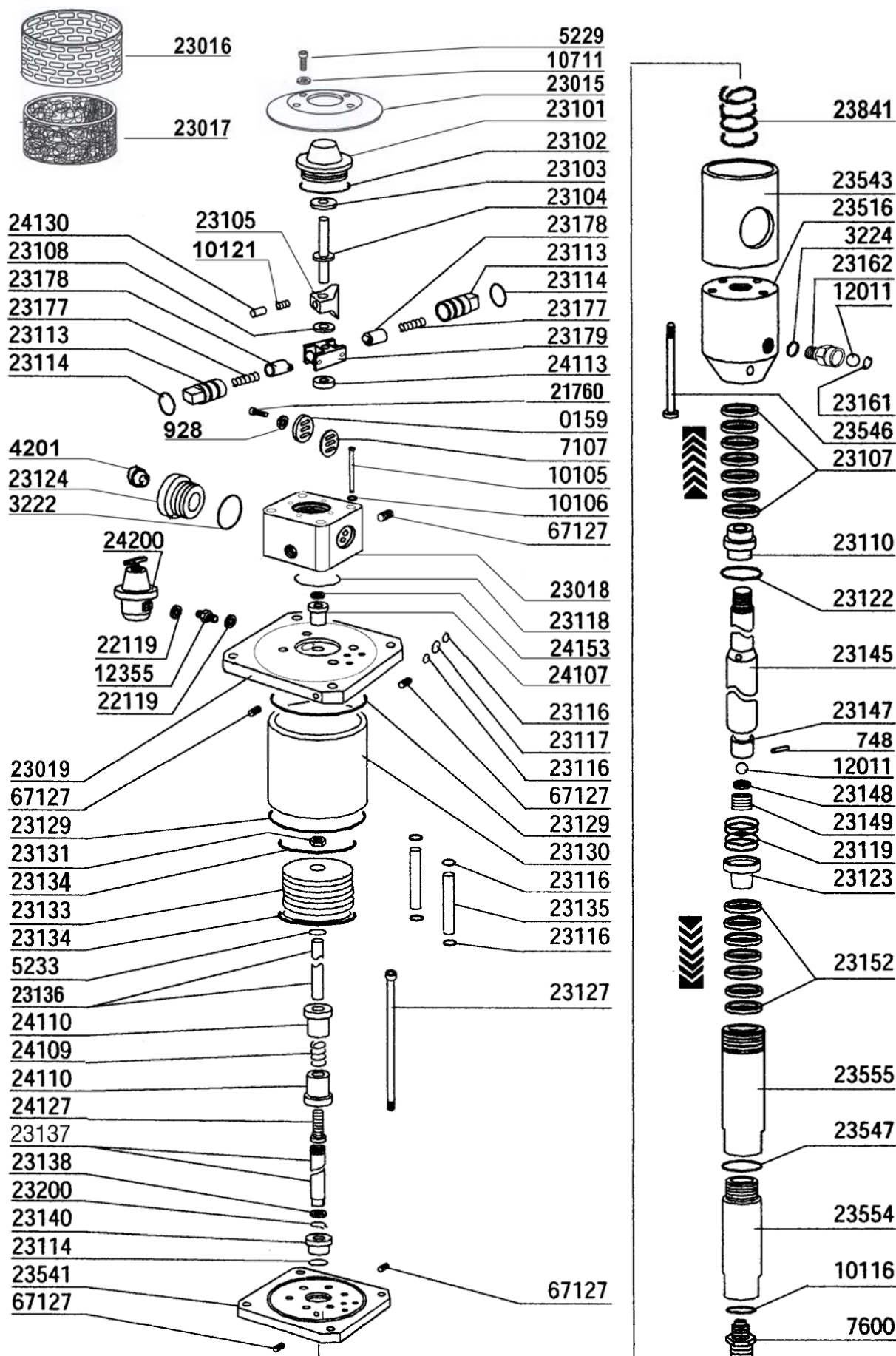

**PART LIST AND DIAGRAM**  
**Pneumatic Airless Pump 12000 P - (40:1)**

Ref.	Description	Q.ty	Ref.	Description	Q.ty
<b>23002</b>	<b>Pneumatic airless pump 12000 P</b>				
000159	CAP	1	023145	PISTON	1
000748	BALL-STOP PIN	1	023147	BALL CONTROL BUSH	1
003222	O.R.	1	023148**	COPPER GASKET	1
003224	COPPER GASKET	1	023149**	BALL SEAT COMPLETE	1
004201	DISCHARGE OIL PLUG	1	023152***	LOWER SEALS	1
005229	FIXING BOLT	4	023161	BALL STOP RING	1
005233	WASHER SCHNOOR	1	023162	NON-BACKFLOW VALVE NIPPLE	1
007107	GASKET	1	023177	SPRING FOR REVERSAL KIT	2
010105	BOLT	4	023178	REVERSAL KIT PISTON	2
010106	WASHER SCHNOOR	4	023179	REVERSAL CONTROL SYSTEM	1
010116*	SUCTION VALVE GASKET	1	023200	RING	1
010121	BALL SPRING	1	023516	MAIN PUMPING HOUSING IN S.S.	1
010711	WASHER	4	023541	LOWER FLANGE	1
012011**	BALL dia.11, S.S.	2	023543	SPACER CYLINDER	1
012355	NIPPLE MM3/8"	1	023546	PUMPING HOUSING BOLT	4
021760	FIXING SCREW	2	023547	SEAL GASKET	1
022119	COPPER GASKET 3/8"	2	023554	LOWER PUMPING HOUSING IN S.S.	1
023015	COVER, MOTOR SILENCER	1	023555	UPPER PUMPING HOUSING IN S.S.	1
023016	FILTER NET	1	023841	SECURITY SPRING	1
023017	SILENCER	1	024107	SELF-LUBRICATING BUSH	1
023018	AIR CONTROL VALVE BODY	1	024109	SPRING	1
023019	UPPER FLANGE	1	024110	UPPER GUIDE	2
023101	COVER COMPLETE WITH BUSH	1	024113	LOWER BUFFER	1
023102	GASKET	1	024127	BOLT	1
023103	UPPER BUFFER	1	024130	SPRING GUIDE	1
023104	PILOT SHAFT	1	024153	LUBRORING	1
023105	AIR CONTROL VALVE SUPPORT	1	024200	PRES. REDUCER 3/8" CPL. WITH GAUGE	1
023107***	UPPER SEALS	1	067127	CONICAL PLUG 1/4"	5
023108	WASHER	1			
023110	UPPER PRESSURE WASHER	1			
023113	PISTON BODY	2			
023114	GASKET	3			
023116	GASKET	8			
023117	GASKET	1			
023118	GASKET	1			
023119	SPRING	1			
023122	GASKET	1			
023123	SUPPORT	1			
023124	AIR CLUTCH FLANGE	1			
023127	SOCKET SCREW	4			
023129	GASKET	2			
023130	AIR CYLINDER	1			
023131	PISTON FIXING NUT	1			
023133	AIR MOTOR PISTON	1			
023134	LUBRORING	2			
023135	AIR CONNECTION TUBE	2			
023136	ROD	1			
023137	SHAFT, MOTOR PISTON	1			
023138	SEEGER	1			
023140	LOWER FLANGE BUSH	1			
07600*	SUCTION VALVE FOR PNEUMATIC	1			

---

**Spare parts suggested:**

---

7608	SUCTION VALVE KIT (*)
10328	DUMP VALVE KIT,S.S.
23318	COMPRESSION VALVE KIT (**)
23803	UPPER AND LOWER PACKINGS SET (***)

---